

## 3" Flush Mount, 25W LED, Round

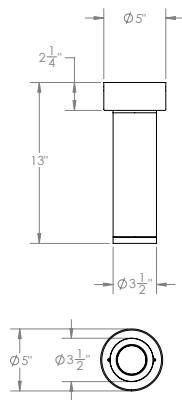

### STANDARD FINISHES

<b>ABL</b> (Aegean Blue)	<b>PNC</b> (Painted Natural Copper)
<b>BB</b> (Burnished Bronze)	<b>RD</b> (Red)
<b>BK</b> (Gloss Black)	<b>SGR</b> (Sage Green)
<b>BLU</b> (Blue)	<b>SND</b> (Sand)
<b>DVG</b> (Dove Gray)	<b>SS</b> (Satin Silver)
<b>FLG</b> (Flannel Gray)	<b>TBZ</b> (Textured Bronze)
<b>GA</b> (Galvanized)	<b>TGP</b> (Textured Graphite)
<b>GWT</b> (Gloss White)	<b>TNG</b> (Tangerine)
<b>LG</b> (Lime Green)	<b>TTL</b> (Tahitian Teal)
<b>MB</b> (Matte Black)	<b>WT</b> (Semi Gloss White)
<b>MBL</b> (Midnight Blue)	<b>YEL</b> (Yellow)
<b>PNA</b> (Painted Natural Aluminum)	

### Electrical Data

CCT	CRI	Wattage	Delivered Lumens	Efficacy
2700K	90 CRI	25W	1550 lm	62 lpw
3000K	90 CRI	25W	1640 lm	65 lpw
3500K	90 CRI	25W	1725 lm	69 lpw
4000K	90 CRI	25W	1795 lm	72 lpw
Warm Dim	-	10W	608 lm	61 lpw

Lumens will vary depending on CCT, optic & lens option

### Specifications

#### Field Replaceable LED Light Engine

- 25W LED with 2 SDCM binning
- 2700K, 3000K, 3500K and 4000K at 90 CRI
- 10°, 30° and 50° optics included
- 45° adjustability with 360° aiming

#### Field Replaceable Dimming Driver

- Multiple dimming drivers available
- Power factor > 0.9, 50/60Hz

#### Mounting

5" x 2-1/4" canopy included with standard universal dim driver. (7-1/8" x 2-1/4" round canopy included with Lutron and eldoLED drivers)

#### Finishes

Available in many colors with optional coastal coating to protect finish in coastal environments

#### Listing / Warranty

- Five (5) year limited warranty
- UL listed to US and Canadian standards for damp location



## Order Matrix

### GyroShift 3" Flush Mount Cylinder (Example: LF3-SFT-10S2710ABL-NLNL-0)

Series	Wattage	Driver	CCT / CRI	Optic	Finishes	Coastal Coating Option	Media 1	Media 2	Rev	Canopy
<b>LF3-SFT</b> (Round)	-10 (10W)	<b>S<sup>2</sup></b> (ERP, Universal Dim, Triac/ELV/0-10V 1% 120-277V)	<b>27</b> (2700K/90 CRI)	<b>10</b>	<b>ABL</b>	(blank) (No coating)	<b>-NL</b> (No Lens)	<b>NL</b>	<b>-0</b>	(blank) (standard canopy)
	-15 (15W)		<b>30</b> (3000K/90 CRI)	<b>30</b>	<b>BB</b>	<b>-C</b> (Coating)	<b>-CL</b> (Clear Lens)	<b>CL</b>		<b>-CC1<sup>3</sup></b> (Conduit 3-1/4" canopy)
	-20 (20W)		<b>35</b> (3500K/90 CRI)	<b>50</b>	<b>BK</b>		<b>-FR</b> (Frosted Lens)	<b>FR</b>		<b>-CC2</b> (Conduit 3-7/8" canopy)
	-25 (25W)	<b>L3<sup>1</sup></b> (Lutron Hi-lume <sup>®</sup> Fade-to-Black 1% 120-277V)	<b>40</b> (4000K/90 CRI)		<b>BLU</b>		<b>-MP</b> (Solite Lens)	<b>MP</b>		
			<b>WD*</b> (1850-3000K)		<b>DVG</b>		<b>-LS</b> (Linear Spread)	<b>LS</b>		
		<b>EL1<sup>1</sup></b> (eldoLED DALI 1% 120-277V)		<b>FLG</b>		<b>-HEX*</b> (Hex Louver)				
		<b>EL2<sup>1</sup></b> (eldoLED 0-10V 1% 120-277V)		<b>GA</b>		<b>-WW*</b> (Wall Wash)				
		<b>DMX<sup>1</sup></b> (DMX 0.1% 120-277V)		<b>GWT</b>						
				<b>LG</b>						
				<b>MB</b>						
				<b>MBL</b>						
				<b>PNA</b>						
				<b>PNC</b>						
				<b>RD</b>						
				<b>SGR</b>						
				<b>SND</b>						
				<b>SS</b>						
				<b>TBZ</b>						
				<b>TGP</b>						
				<b>TNG</b>						
				<b>TTL</b>						
				<b>WT</b>						
				<b>YEL</b>						

1. Includes larger canopy
2. Forward and reverse dimming at 120V only
3. CC1 and CC2 only for S driver option

### Media

<b>S3-LENS-CL-0</b> (Clear Lens)	<b>S3-LENS-LS-0</b> (Linear Spread)	*Note: Can only fit 1 media if HEX or WW is selected
<b>S3-LENS-FR-0</b> (Frosted Lens)	<b>S3-LENS-HEX-0*</b> (Hex Louver)	
<b>S3-LENS-MP-0</b> (Solite Lens)	<b>S3-LENS-WW-0*</b> (Wall Wash)	

### Emergency

<b>EM-1000</b> (25W LED Remote Inverter)
<b>EM-1002</b> (10W LED Remote Emergency Driver)